

## PAPER CRAFT

<http://www.canon.com/c-park/en/>

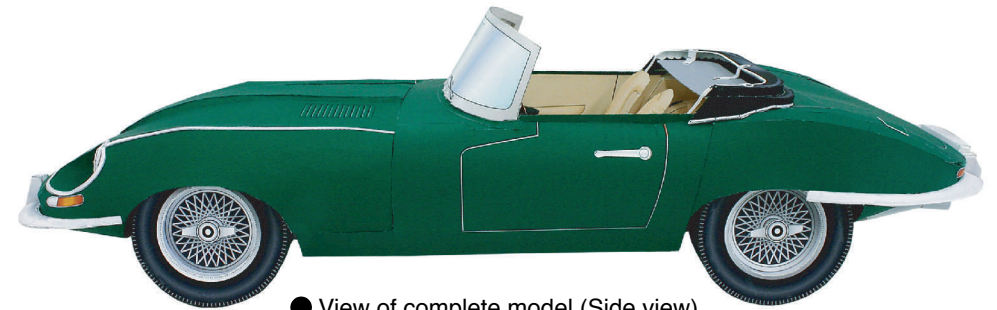

● View of complete model (Side view)

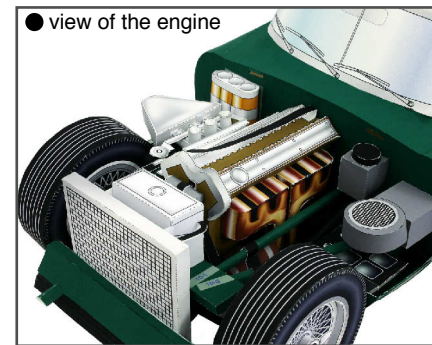

● view of the engine



● view of the cockpit

### JAGUAR E-type

"Jaguar E-type" is one of the most well-known models produced by British sports car maker Jaguar, founded in 1922. This model was highly regarded at the Geneva International Motor Show in March 1961 for its low-set, streamlined appearance and state-of-the-art mechanics. Series 1, which first went on the market in 1961, sported an inline six-cylinder, 3.8 liter DOHC engine. In 1964, this was upgraded to a 4.2 liter. Various minor changes up until 1971 resulted in the twin-six engine of the Series 3. This model, known in the US as the XK-E, enjoyed high levels of popularity.

Although the E-type disappeared from the market in 1975, its curved lines continued to influence designers, and it remained well-loved by car enthusiasts around the world.

This Papercraft JAGUAR E-type is about one thirteen the size of the real car.

\*This model was designed for Papercraft and may differ from the original in some respects.

■ Parts list (Pattern) : Seventeen A4 sheets (No.1 ~ No.17)

■ No. of Parts: 268

\*Build the model by carefully reading the Assembly Instructions, in the parts sheet page order.

### Assembly Instructions



**Mountain fold**

● Make a Mountain fold



**Scissors line**

● Cut along the line



**Valley fold**

● Make a Valley fold



**Cut in Line**

● Cut along the red solid line



Completed parts become a cylinder



**Layer wrapping (roll)**  
Wrap around and glue to the cylinder, to use as a glue tab



Wrap around and glue to the top of the cylinder.



**How to make the cylinders**

This craft involves making cylinders with diameters of 3 to 7mm, so it may be helpful to have some rods of sizes about 0.5mm thinner handy.

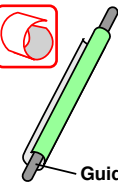

Guide rod



Trace along the folds with a ruler and a used pen (no ink) to get a sharper, easier fold.

Glue, scissors and other tools may be dangerous to young children so be sure to keep them out of the reach of young children.

### Glue tab notation key

Each glue tab has a symbol and number printed on it. △ marks surfaces to put glue on; they should then be glued to the corresponding ▲.

△	▲ Apply glue here
▲	△ Attach here
■	Glue to the rear of the other part

Apply glue to side 2-A and attach together

\*Removable spray adhesive is best when gluing large surfaces.

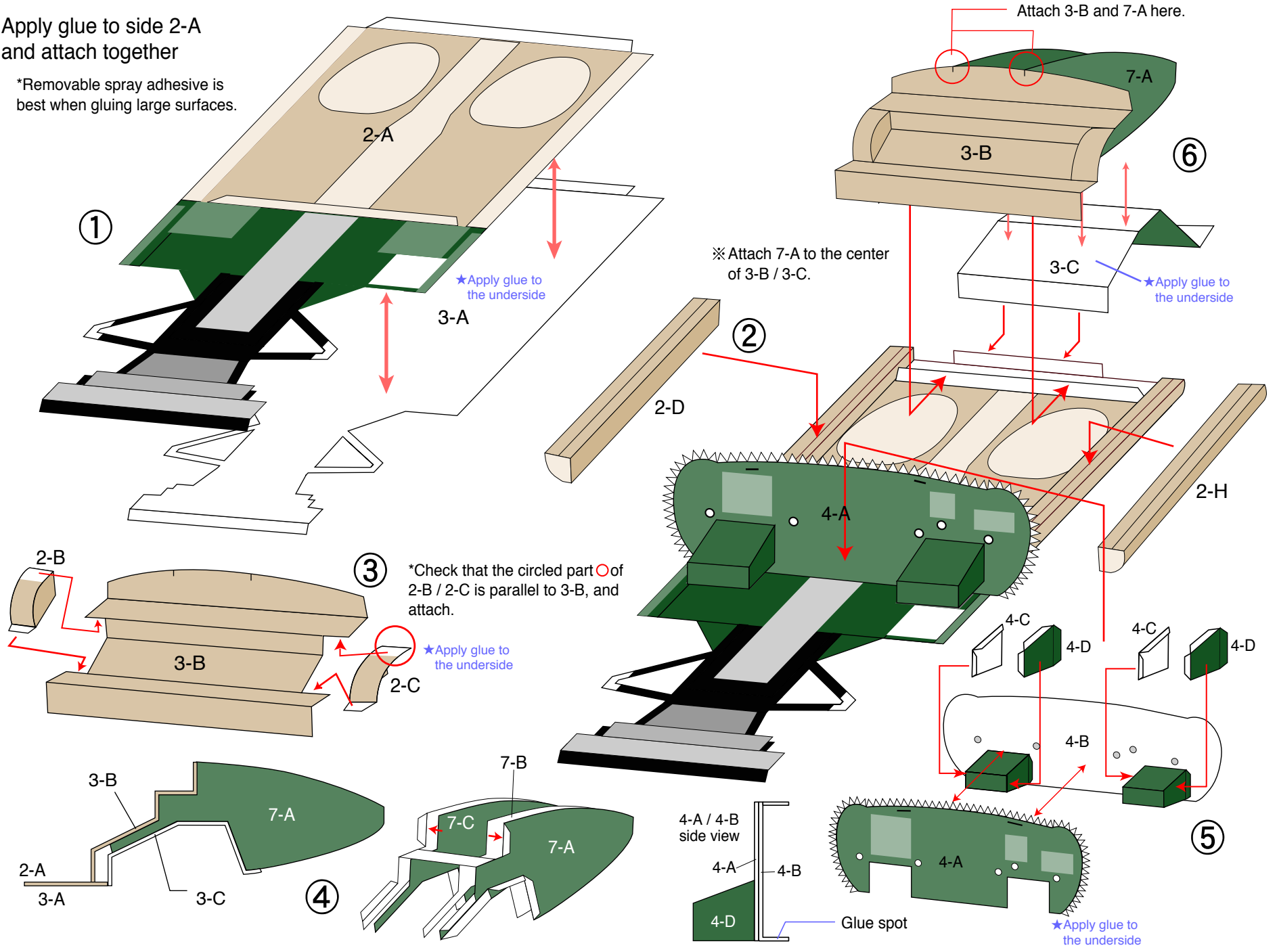

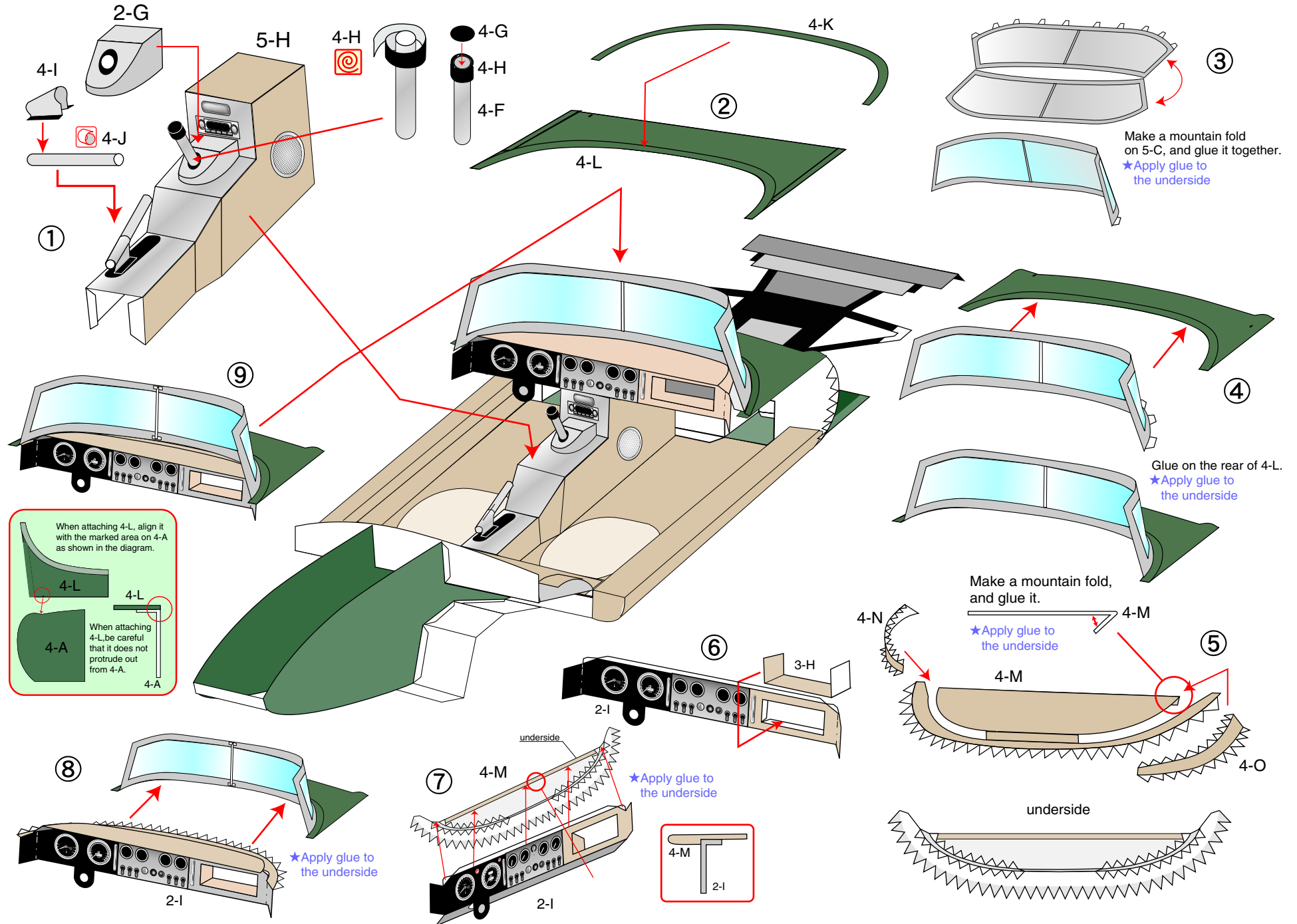

## If using overhead projector film for the windscreen

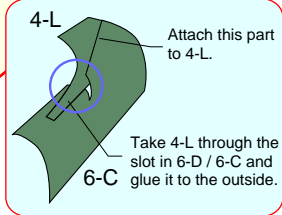
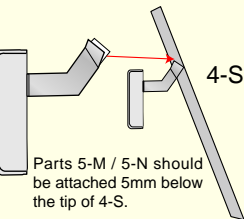
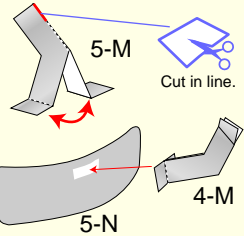
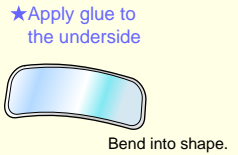
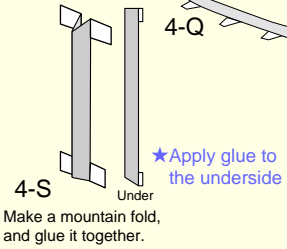
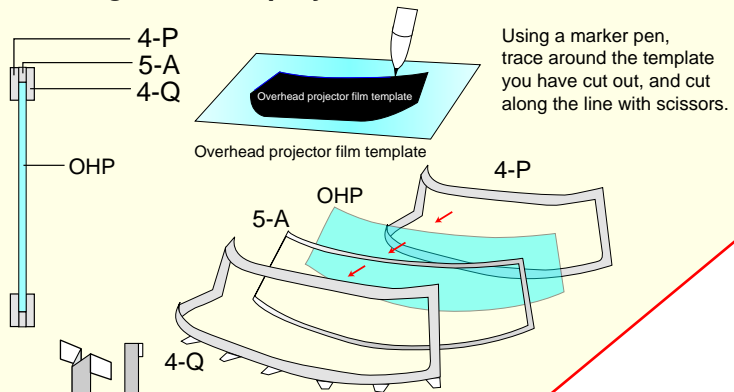

Do not apply glue to this part of 2-l.

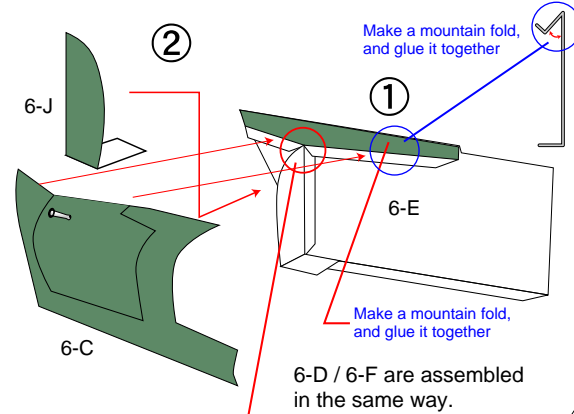
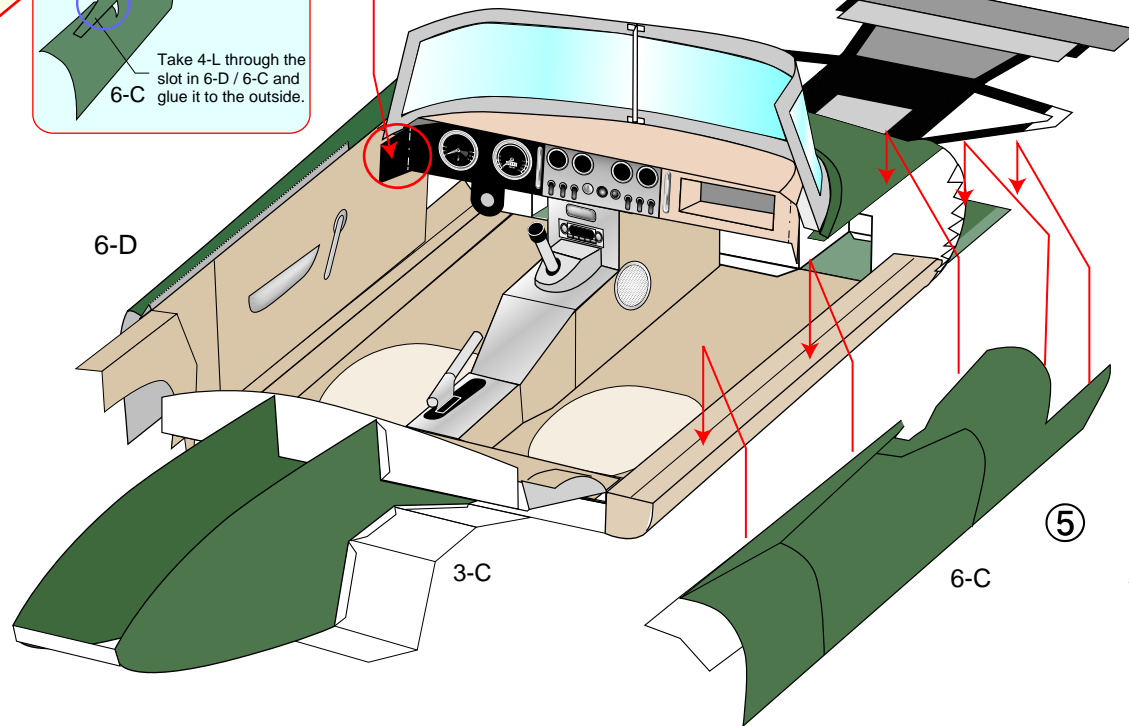

Align 6-l / 6-J with the apex of the triangle depicted here on 6-E / 6-F, and glue perpendicular to the base.

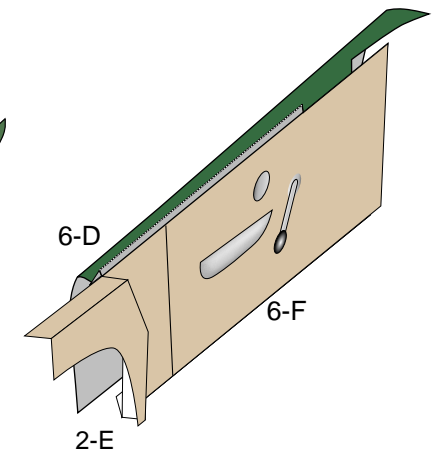
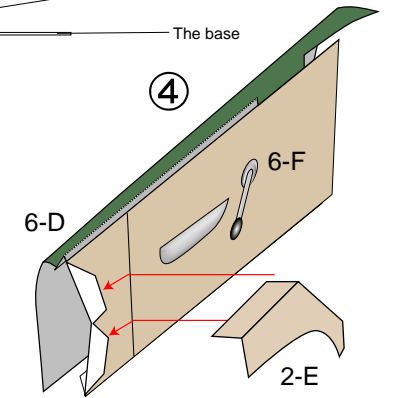
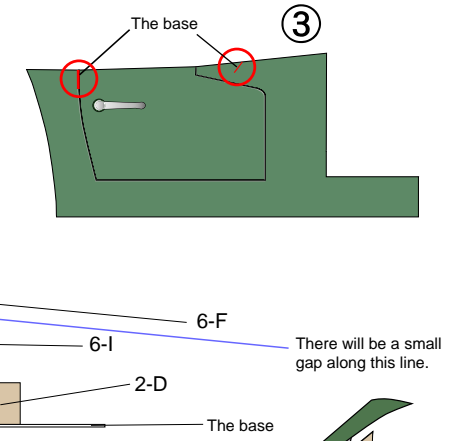

①

## How to assemble the seats

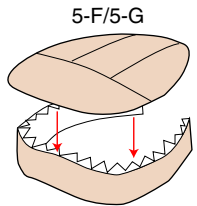
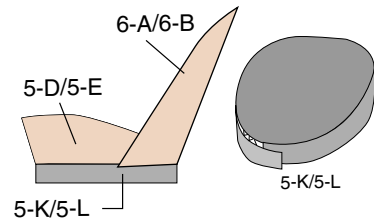

\*Glue along the curved line, beginning at the center front and progressing backwards.

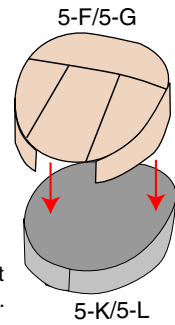

Line up 5-D / 5-E with the curved shape of 5-K/5-L, and glue them together.

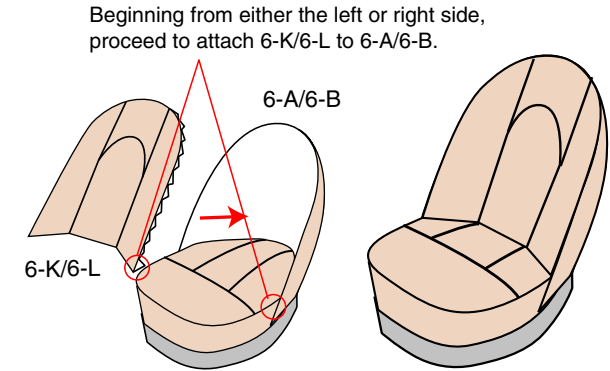
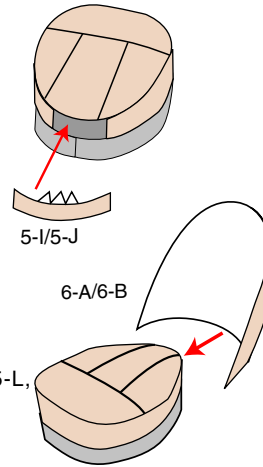

Beginning from either the left or right side, proceed to attach 6-K/6-L to 6-A/6-B.

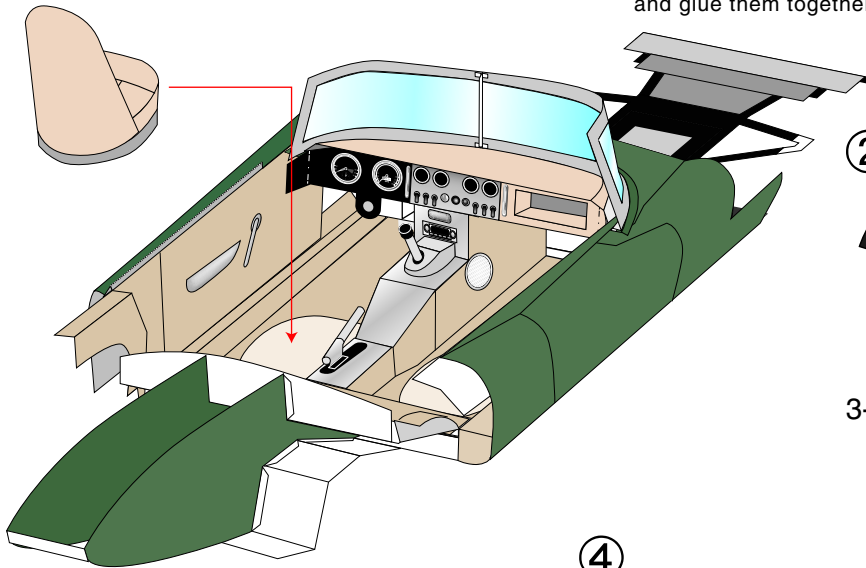

②

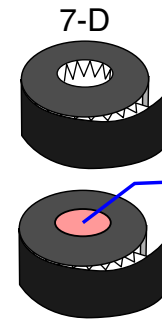
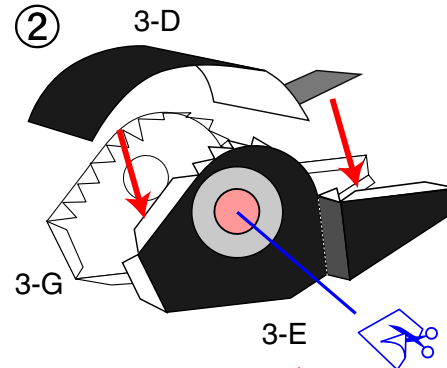

③

7-D/7-E can be used on the right or the left. Attach them to 7-H so that the part you have cut out faces outwards.

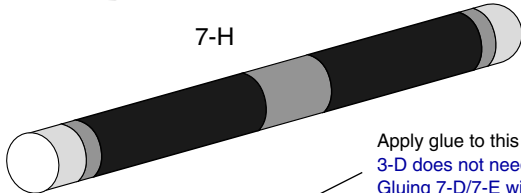

④

Insert 7-H through 3-D.

Apply glue to this area on the left and right.  
3-D does not need to be glued.  
Gluing 7-D/7-E will keep it in place.

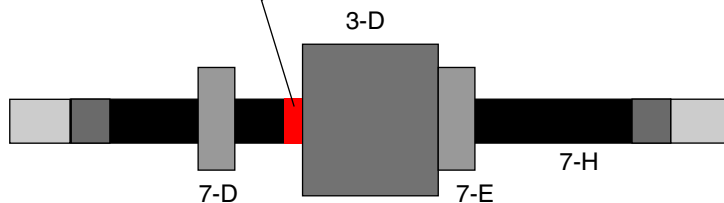

⑤

Attach to the body

8-G

After attaching 8-G/8-H, attach 8-E to the specified part on the body.

8-E

Attach to the body

8-H

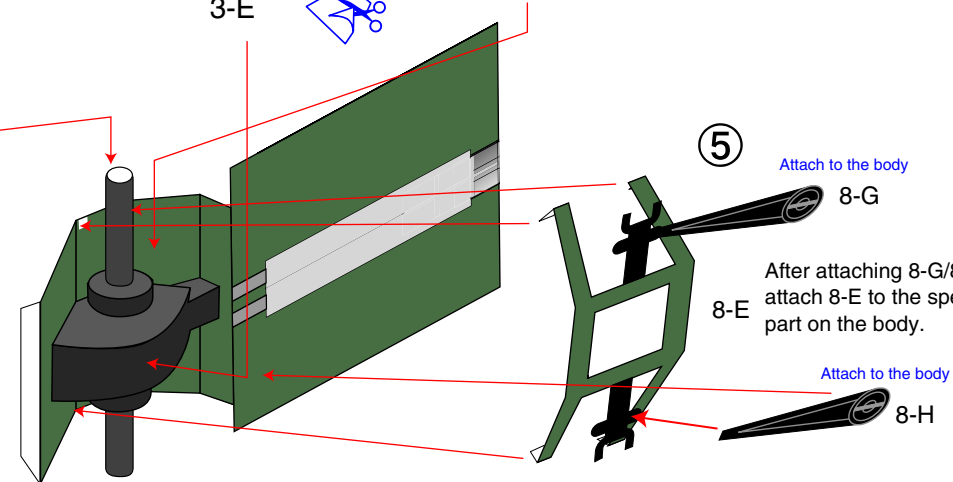

Attach 7-F / 7-G by gluing the 7-L glue tabs to the underside. Stick the 7-L glue tabs along the edges of 7-F / 7-G.

*\*Attach the glue tabs so that they overlap each other.*

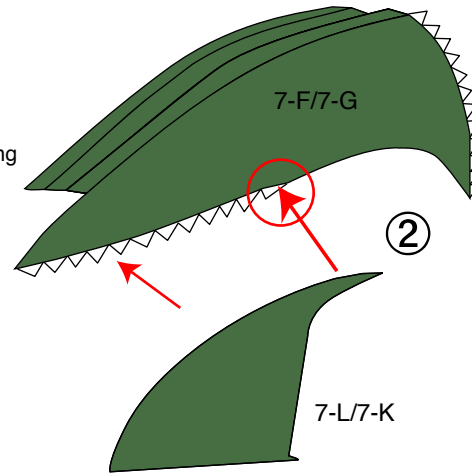
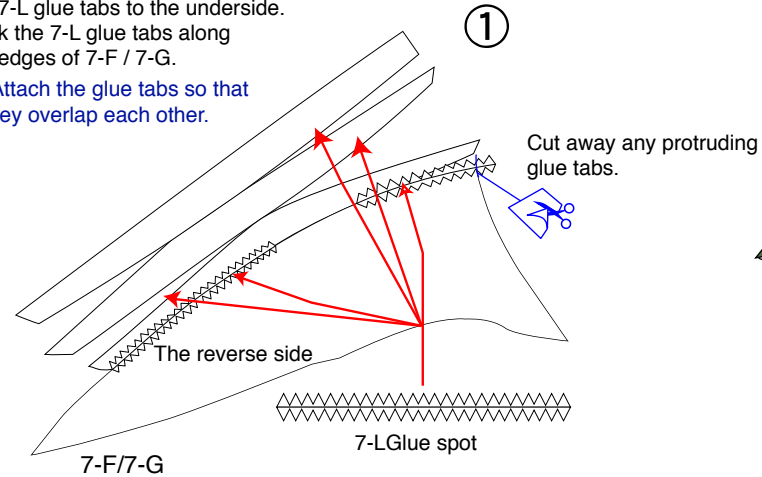

Align 8-L / 8-K very carefully with the area circled, and attach.

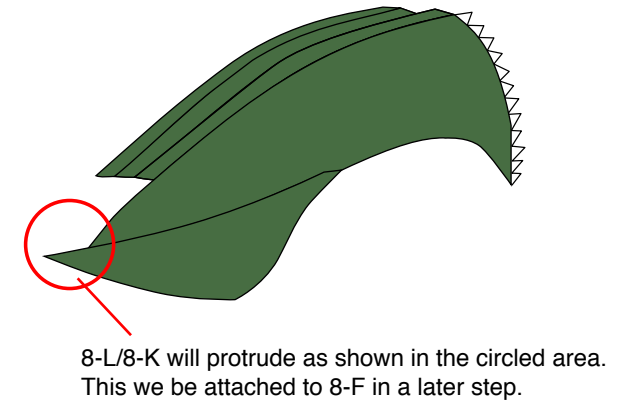

Glue the upper and lower glue tabs of 8-F to the center panel.

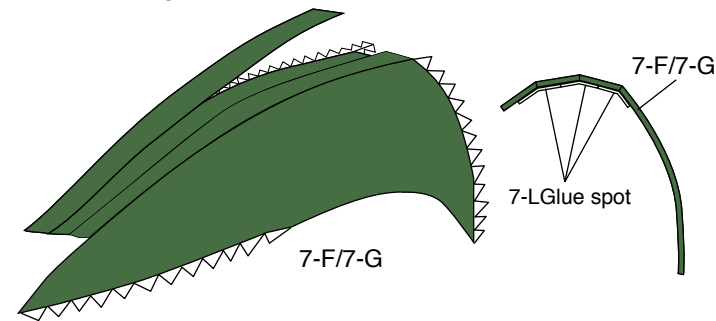

Attach 8-F to the glue tabs on 3-C.

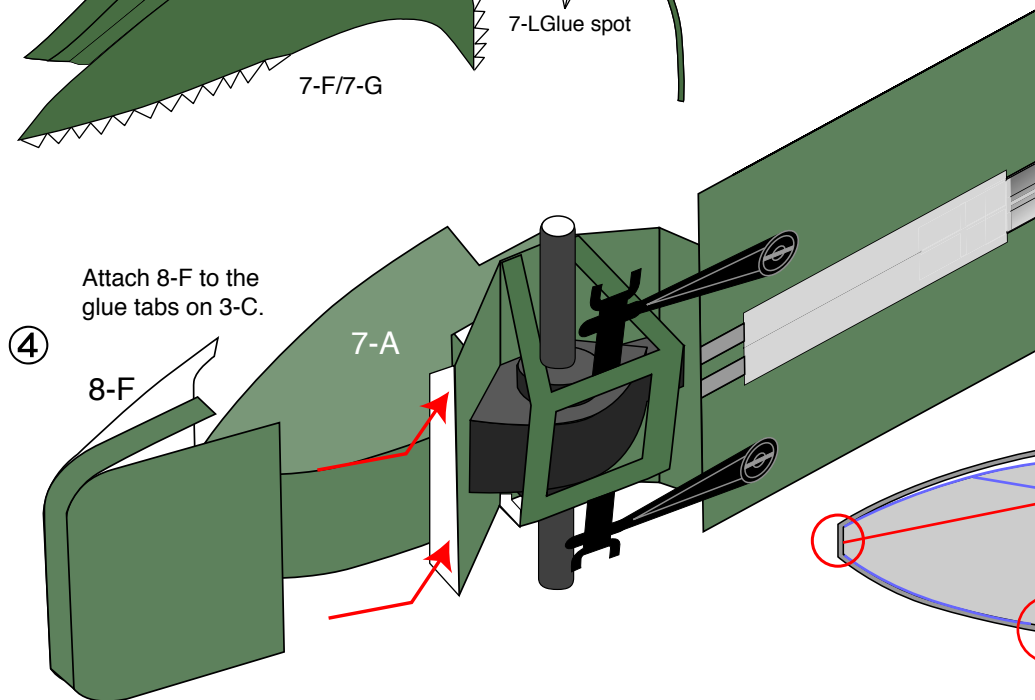

Attach 8-F to the glue tabs on 3-C/7-A.

The area along the blue line does not need to be glued down. 7-A's purpose is to make the rear body stronger. It is best if 8-F is slightly separated from 7-A.

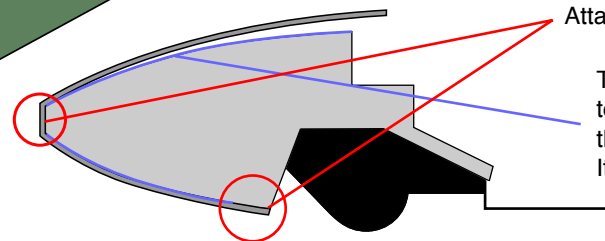

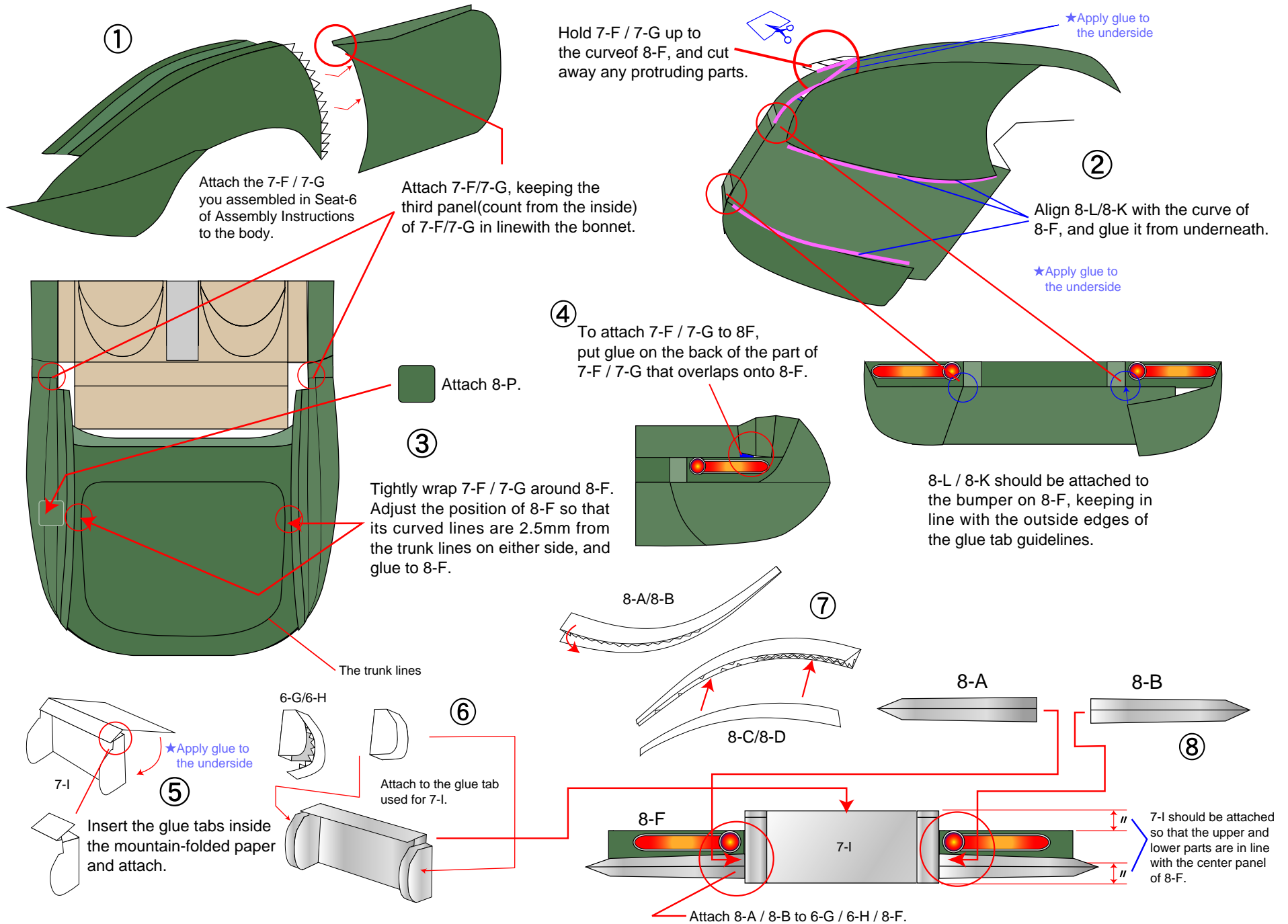

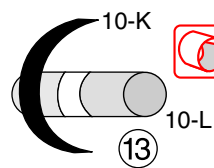
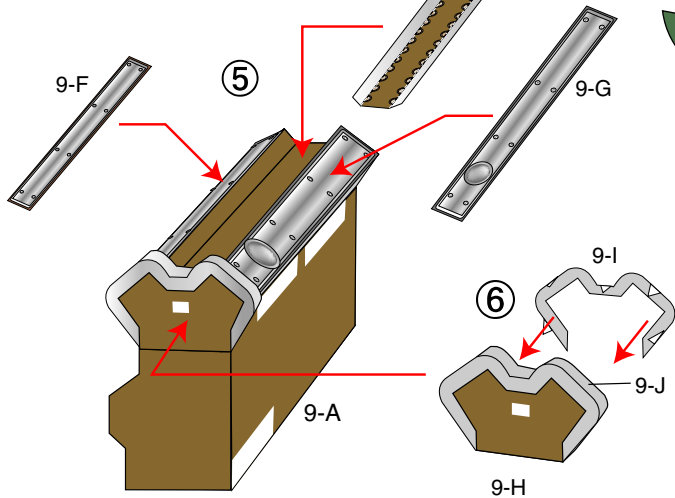
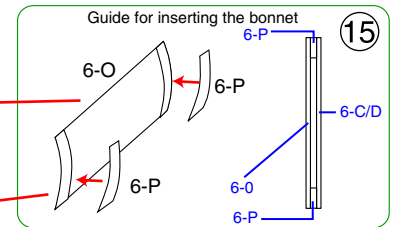
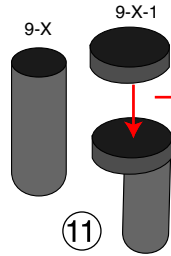
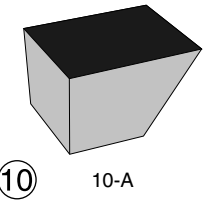
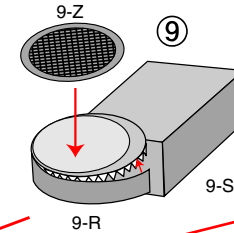
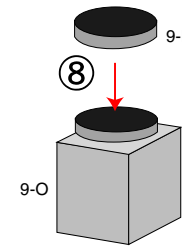
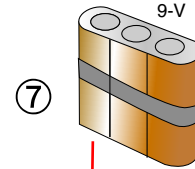
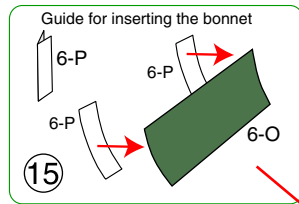
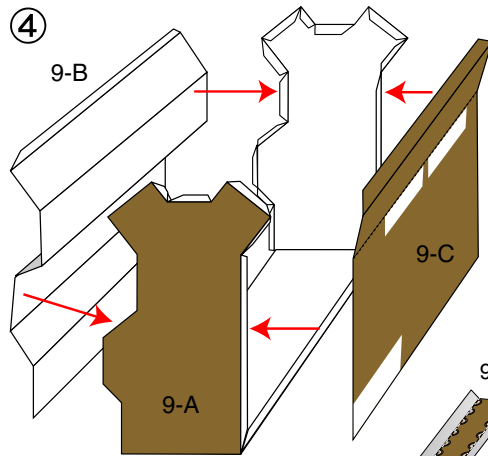
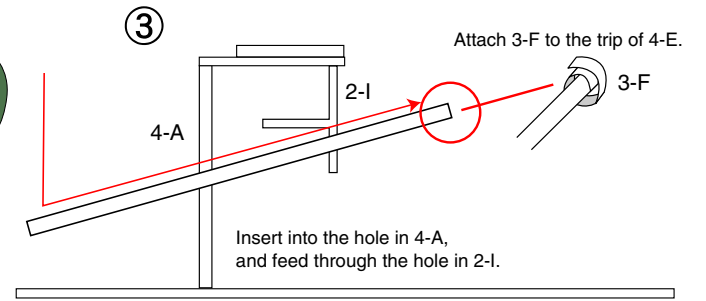
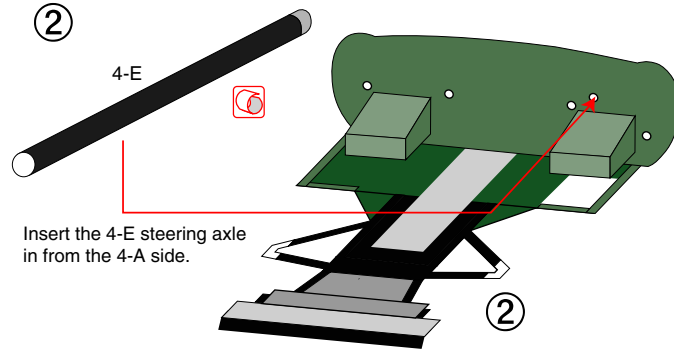
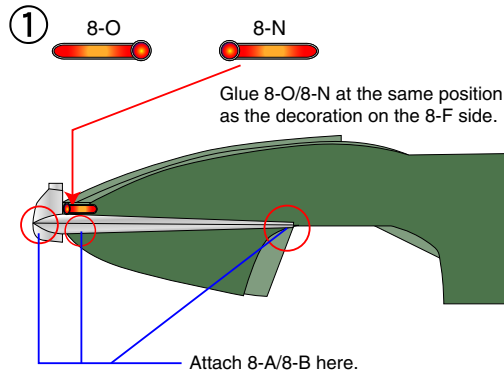

★Apply glue to the underside

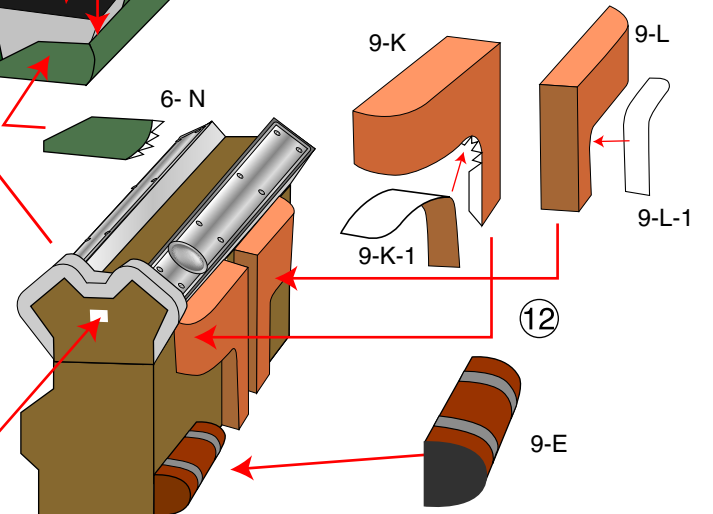



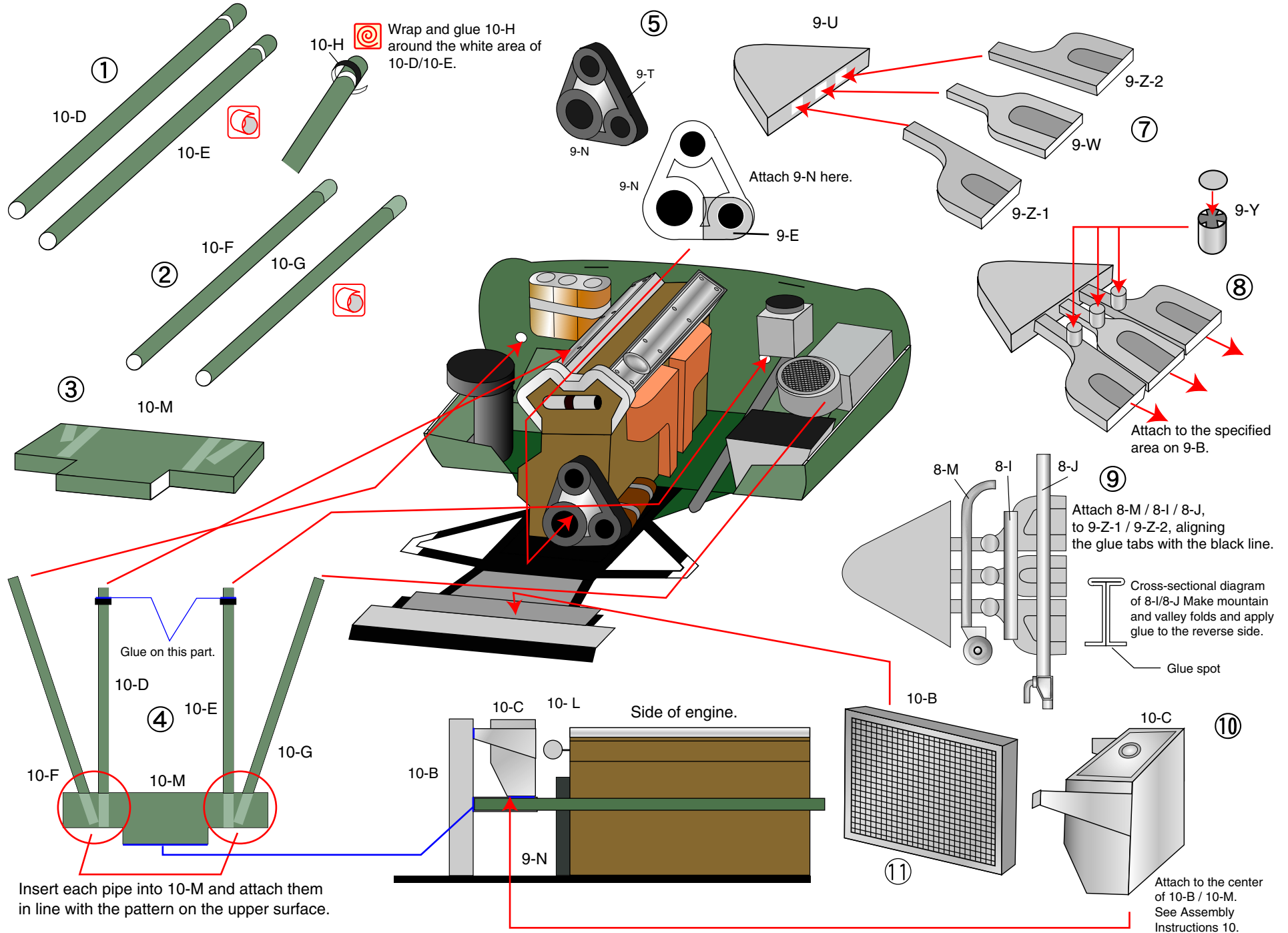

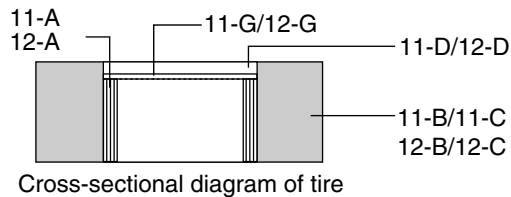
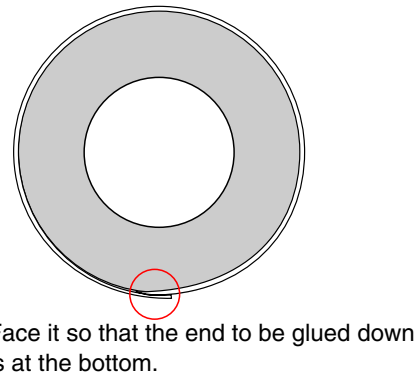
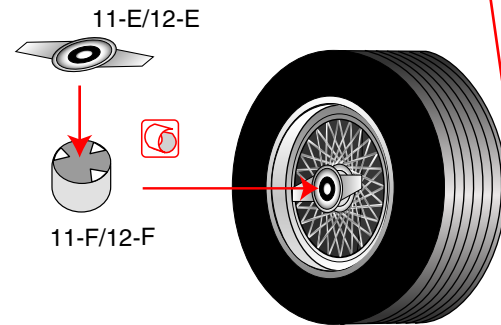
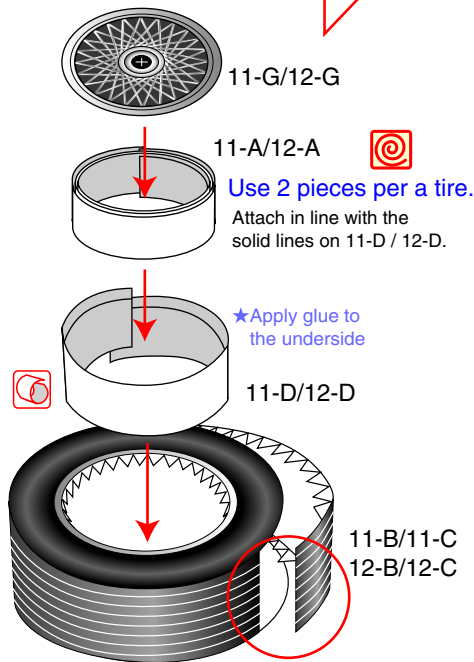
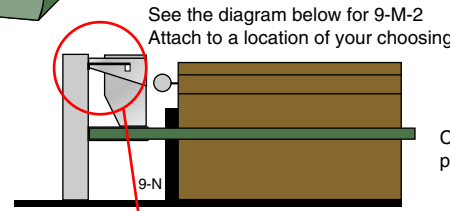
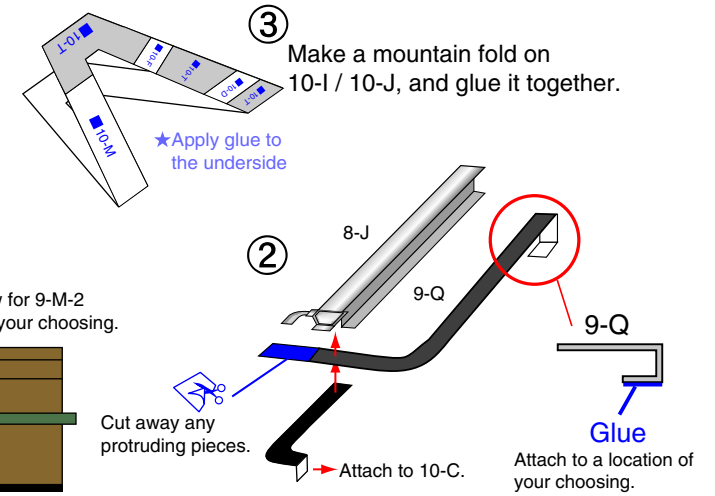
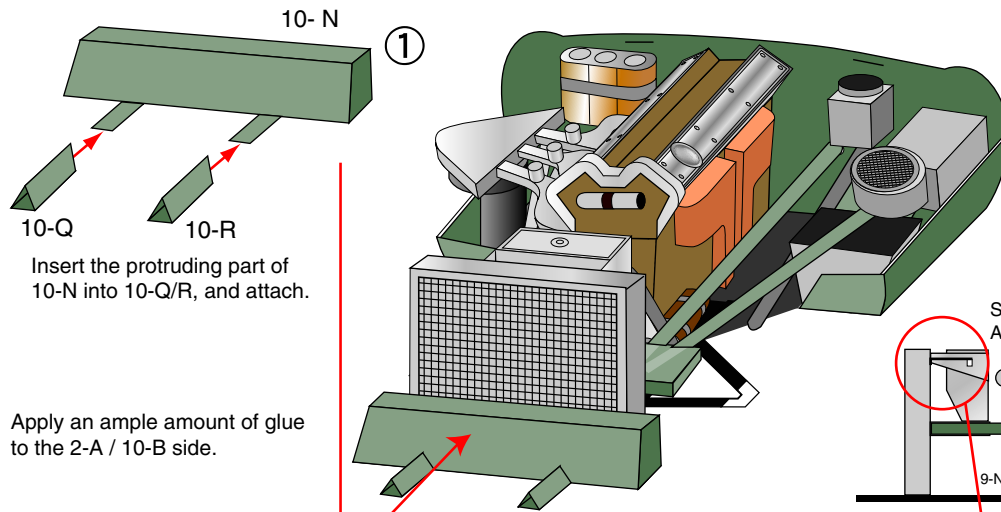

Attach 9-M-1 / 9-M-2 / 9-Q here.

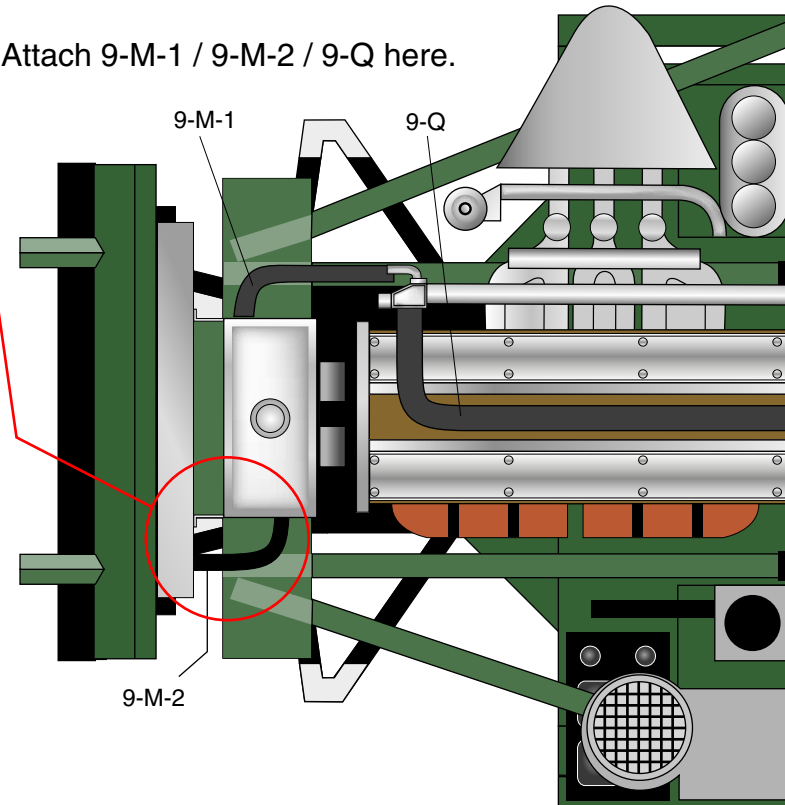

Overhead view of the engine (actual size)

## Attach the rear tires

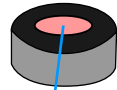
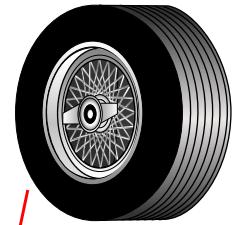

11-I/11-H

①

Cut out this section on the tire side, and make mountain folds to the glue tabs.

11-B

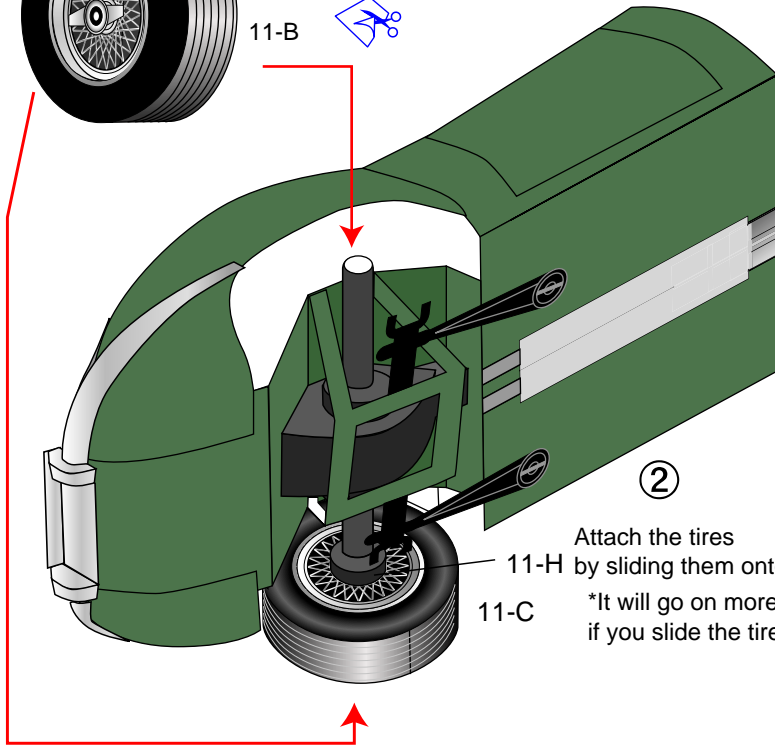

②

Attach the tires by sliding them onto 7-H.  
\*It will go on more easily if you slide the tire on at an angle.

11-H

11-C

③

12-H/12-I

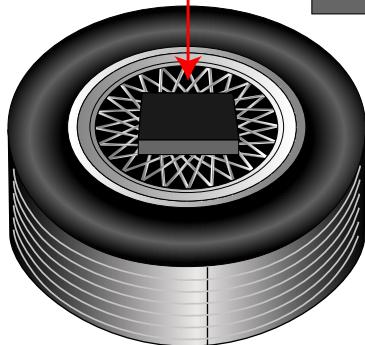

⑤

Attach the front tyres by inserting them between 10-I/10-J and 2-A.

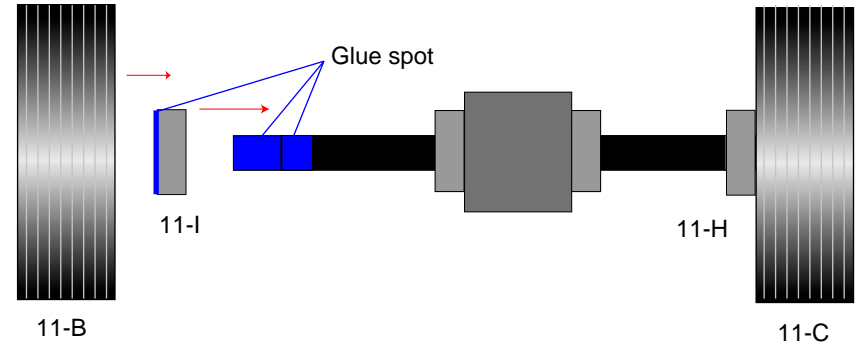
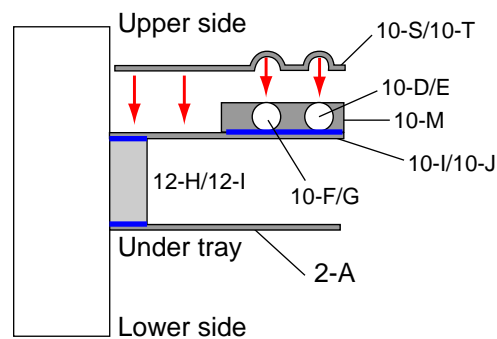

10-S/10-T

Attach front tires here (actual size)

Hold your model up to the diagram below and check the positioning of the tires before attaching.

Attach 10-I/10-J from underneath 10-D/E and 10-F/G.  
Attach 10-S/T from the top.

④

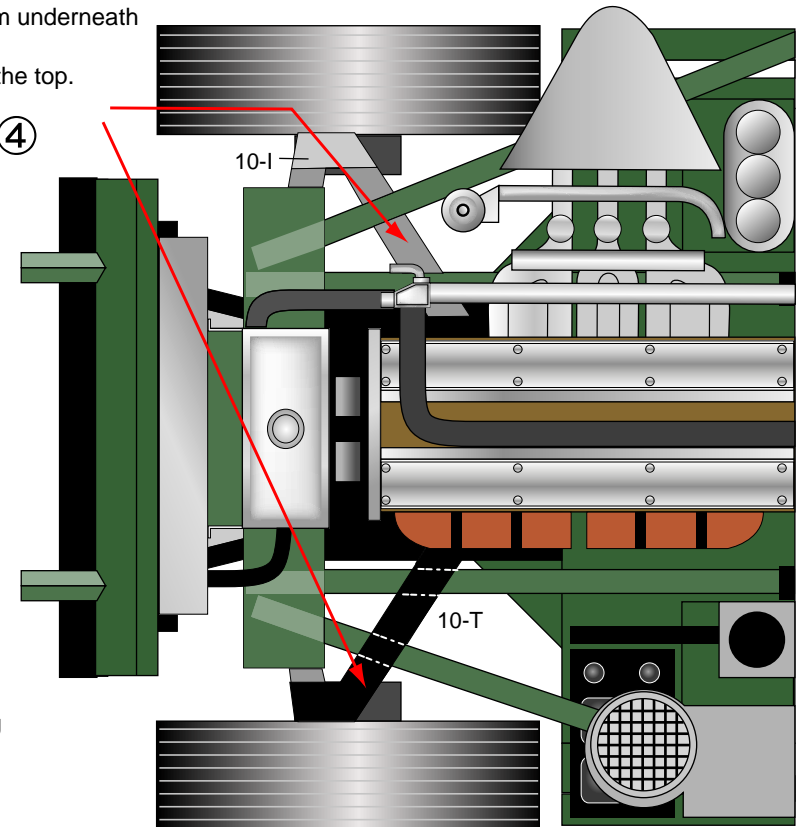

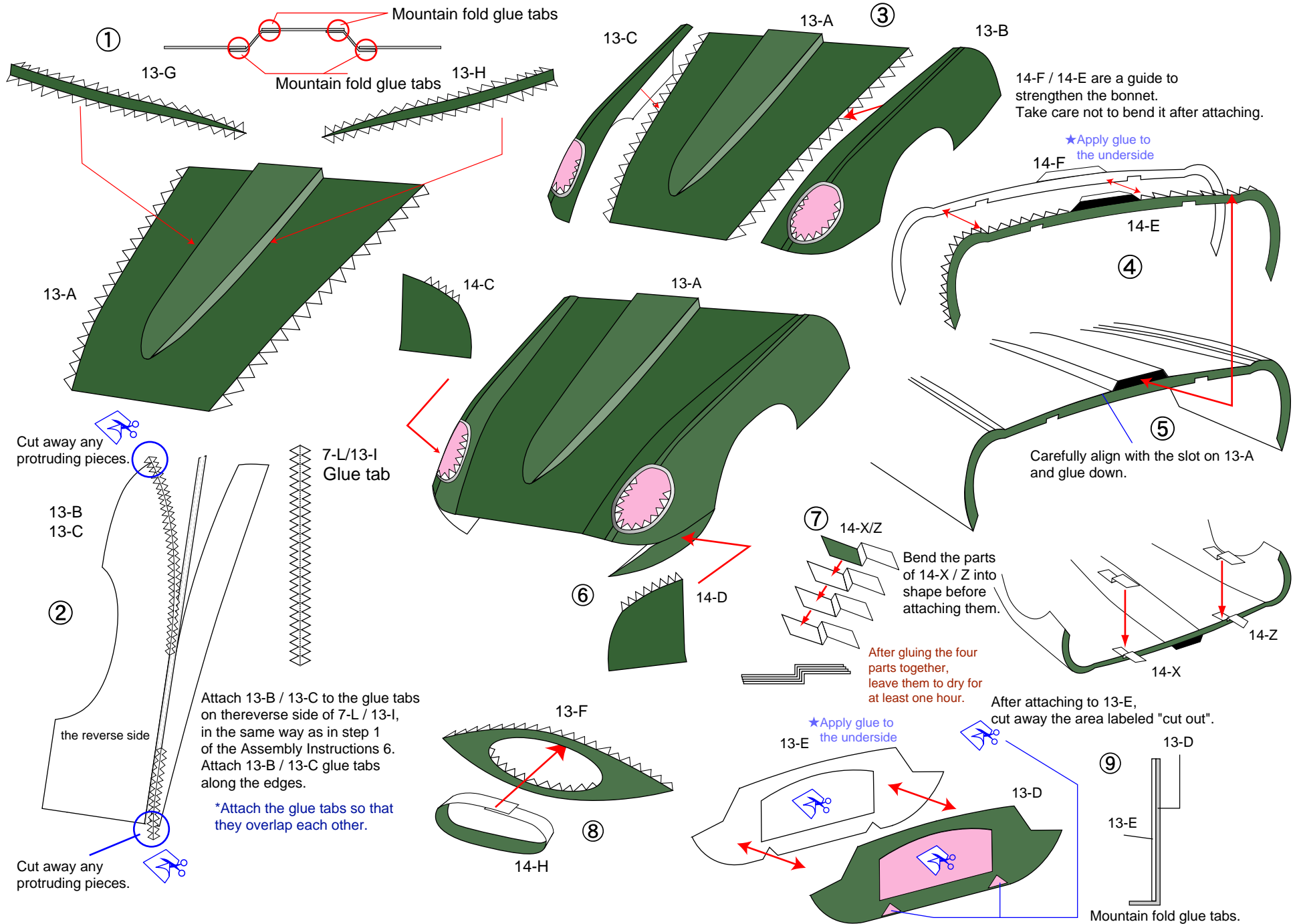

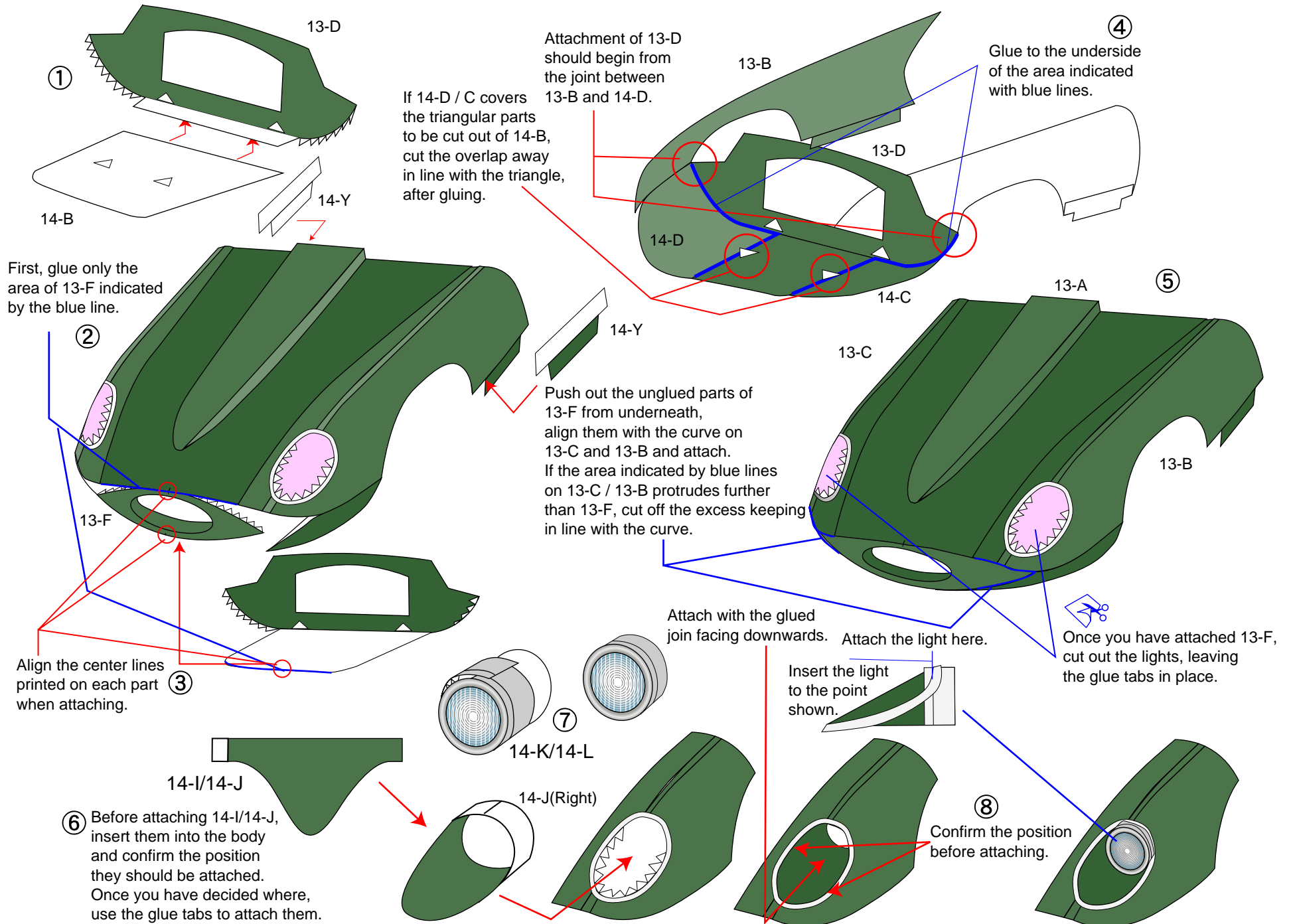

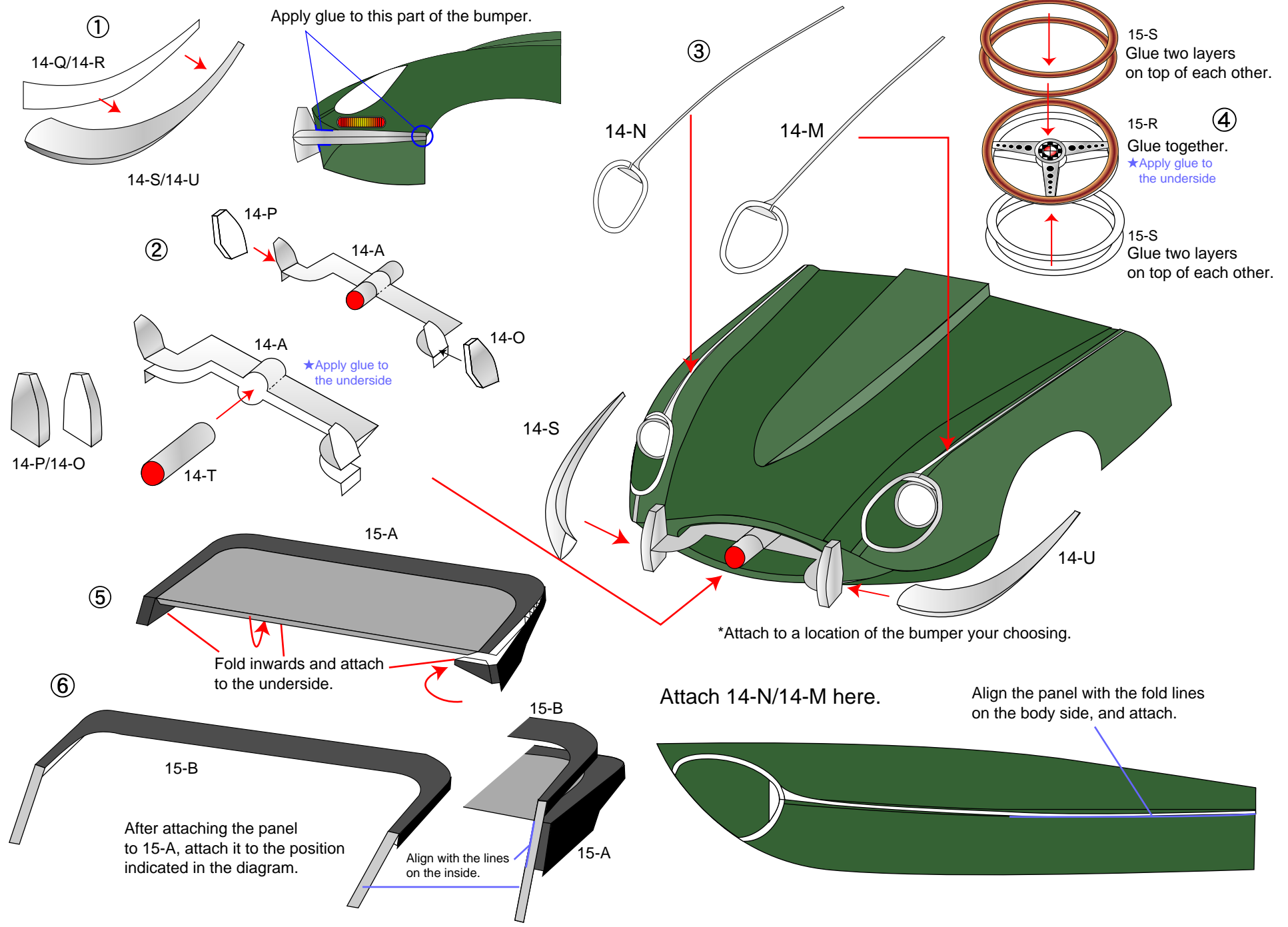

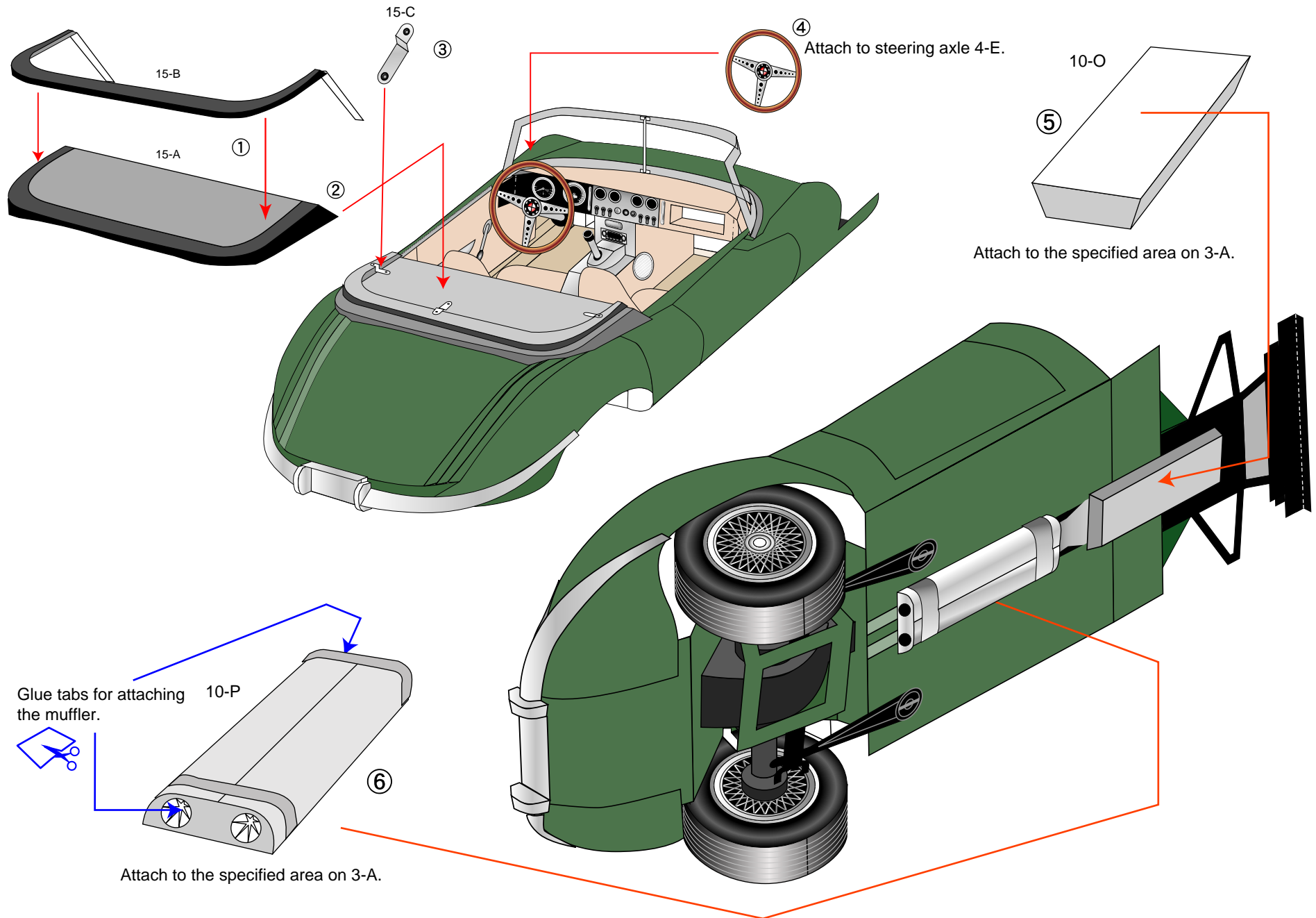

**Assembling the Muffler**

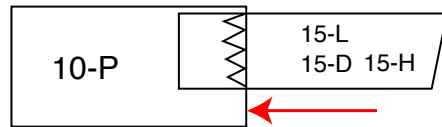
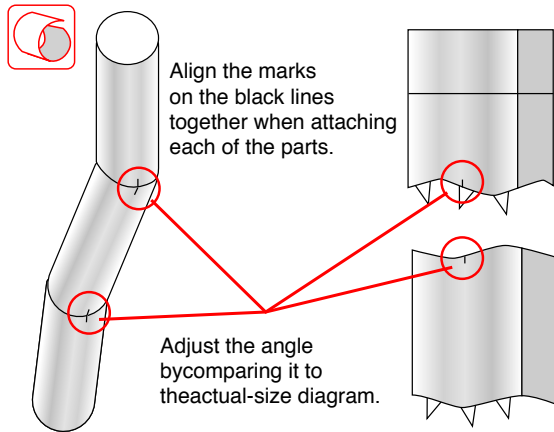

Insert 15-D / 15-H / 15-L into the 10-P side and attach.

**Where to Attach the Muffler (template to scale)**



Hold parts against this template when attaching.

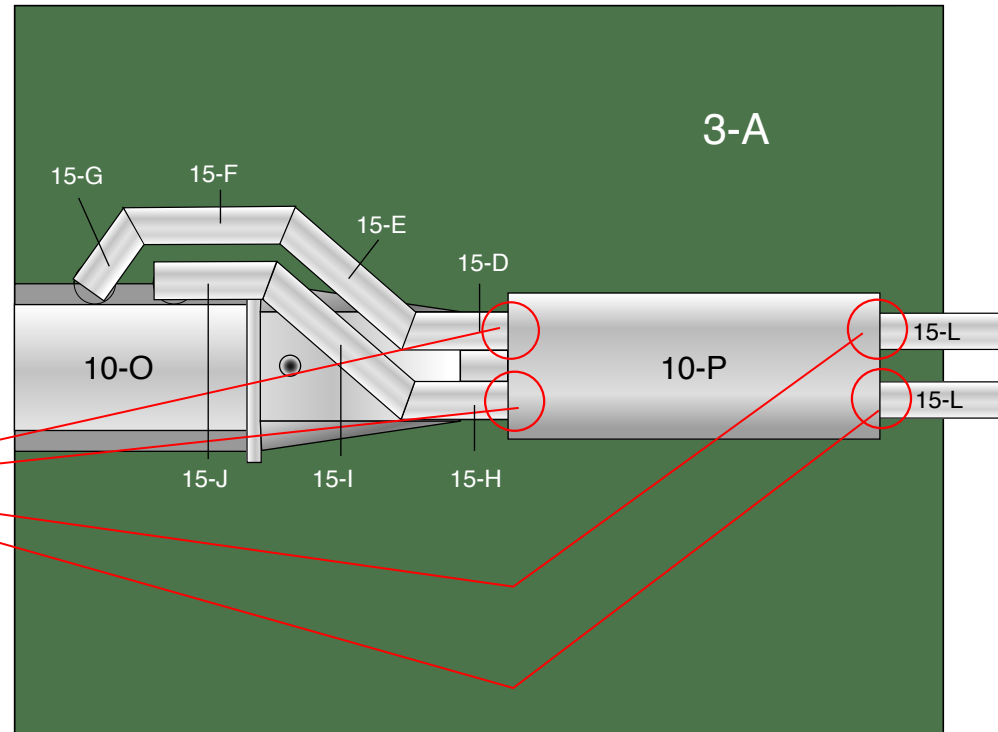

Attach the completed muffler to the position indicated on 3-A.

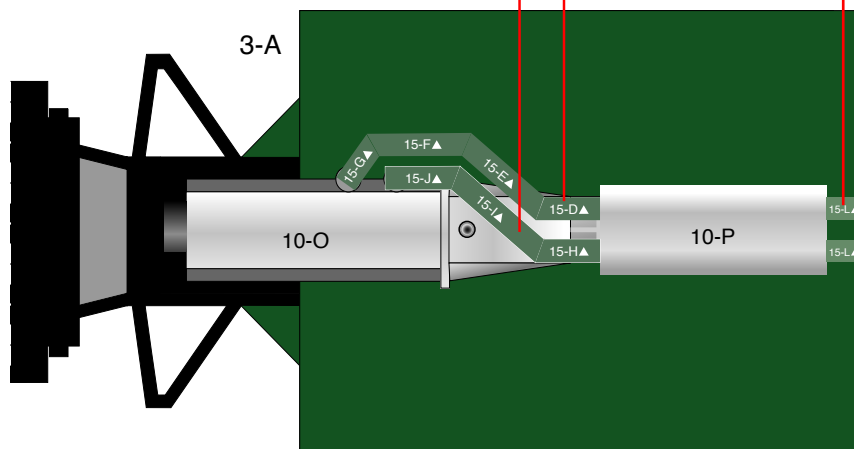

**Side view diagram of rear side**

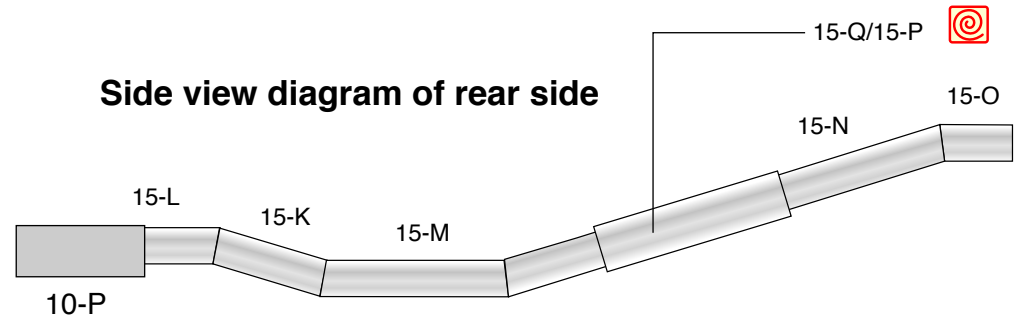



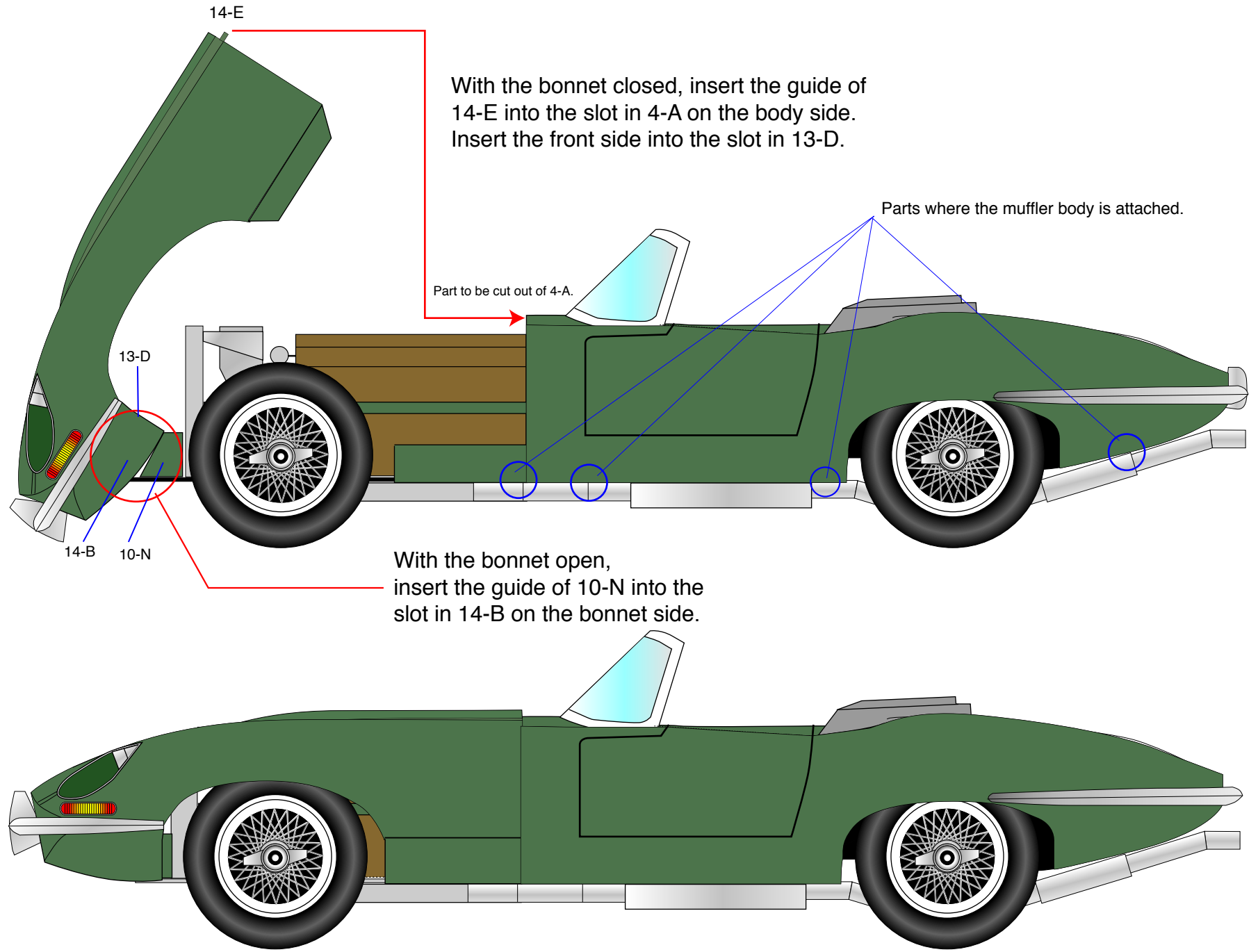

With the bonnet closed, insert the guide of 14-E into the slot in 4-A on the body side. Insert the front side into the slot in 13-D.

Parts where the muffler body is attached.

Part to be cut out of 4-A.

With the bonnet open, insert the guide of 10-N into the slot in 14-B on the bonnet side.